

Palnut® Stamped Nuts

Threaded - Lock-Nut / Washer

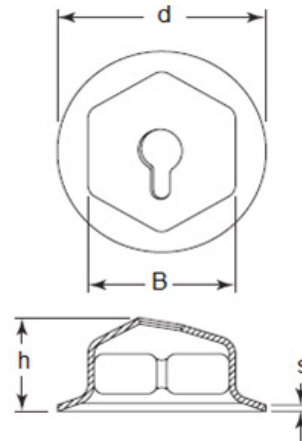

APPLICATION INFORMATION

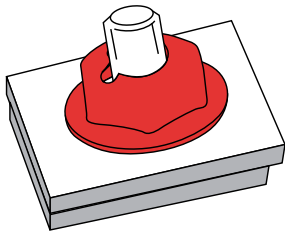

- Used in place of traditional hex nuts for reduced weight or applications requiring lower torques
- Parts feature a stamped, integral washer allowing the part to accommodate a larger hole without the need for a separate loose washer
- Sealants can be applied to reduce moisture and noise intrusion

DESIGN VARIATIONS

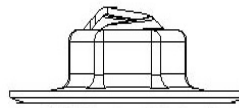

(D) WASHER DISHED

- D - Provides protection to the mating panel



advancecomponents.com 972-446-5500



On Studs

Palnut® Stamped Nuts

Threaded - Lock-Nut / Washer

Imperial

Part Number	Legacy Part Number	Thread Specification	Drive (B)	Diameter (d)	Height (h)	Material Thickness (s)	Design Variation
138135	DZ 002191	6-20	11/32"	0.469	0.212	0.014	-
138110	DO 632007	6-32	5/16"	0.437	0.204	0.014	-
138112	DO 832075	8-32	11/32"	0.469	0.212	0.014	-
138111	DO 832010	8-32	11/32"	0.625	0.234	0.015	-
138105	DO 102408	10-24	3/8"	0.500	0.231	0.017	-
138107	DO 102412	10-24	3/8"	0.750	0.269	0.017	-
138109	DO 142095	1/4-20	7/16"	0.594	0.261	0.020	-
138108	DO 142013	1/4-20	7/16"	0.812	0.292	0.020	-

Metric

Part Number	Legacy Part Number	Thread Specification	Drive (B)	Diameter (d)	Height (h)	Material Thickness (s)	Design Variation
138099	DO 040012	M4x0.7	9mm	12.00	5.65	0.36	-
138100	DO 050014	M5x0.8	10mm	14.00	5.79	0.38	-
138134	DZ 002171	M6x1.0	11mm	21.00	6.86	0.46	D (Dished)
138104	DO 060024	M6x1.0	11mm	24.00	7.75	0.46	-
138101	DO 051614	M5x1.6	10mm	14.00	6.40	0.46	-
138102	DO 051619	M5x1.6	10mm	18.88	7.35	0.43	-
138136	DZ 051612	M5x1.6	11mm	21.00	6.85	0.46	D (Dished)

Most parts manufactured in spring steel

Speed Nuts® & Palnuts®



advancecomponents.com 972-446-5500